



**W. Schmid AG**

LED-Technology  
the visible difference

## LED-ill. Push Button LDT17



LDT17 - LED-ill. Push Button 5/12/24/36/48 VDC

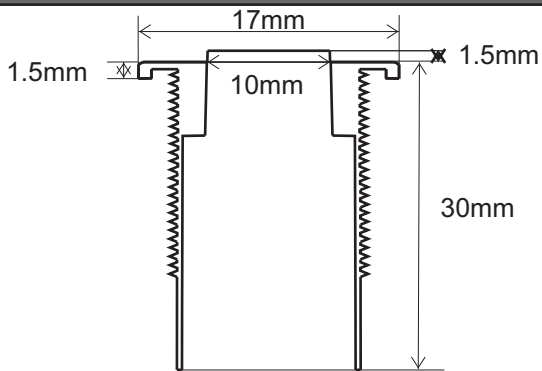

Nut M14x1 / SW 17mm  
O-ring 1mm

momentary  
contact  
element



LED

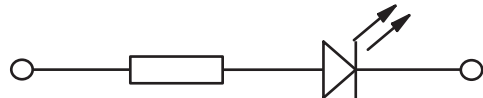

Contact element max. 32 VDC / 50mA  
LED for 5/12/24/36/48 VDC

- 14mm mounting hole
- 10mm colored or white opaque epoxy lens
- colorless or black hard anodized aluminum housing
- connection side encapsulation
- shock- and vibration resistant
- long life-time >50'000 hours for the LED, >500'000 operations for the switch
- LED-variants from 5 VDC to 48 VDC using momentary push-button max. 32 VDC/50mA
- faston or cable connection available
- for use in the chemical industry, machine building, railways, mining or access control

## Technical specifications

Color	Wavelength
red	640nm
yellow	590nm
green	570nm
orange	625nm
blue	470nm
white	$X = 0.3 / Y = 0.32$

### Current consumption

20 mA (12/24 VDC), 10-20 mA (48 VDC)

### Operating and storage temperature

-40 °C up to +85°C

## Standard options

### Series

LDT = LED-ill. push button

### Diameter

17 = 17mm

### Terminals

L = soldering leads

F = faston terminals 2,8 x 0,8mm

C = cable connection 1,2m

### Color code

1 = red            6 = blue

2 = yellow       7 = white

3 = green        8 = red-green

4 = orange    136 = red-green-blue

### Lens

C = colored

W = white

### Voltages

D = VDC, 5 - 48 VDC

A =

### Housing

A = standard aluminum, hard anodized, colorless

B = aluminum anodized, black

N = nickel plated aluminum

C = chrome plated aluminum

### Nut

P = Standard black plastic, glass fibre reinforced

M = Metal nut

### Ordering example

LDT17 F1 C24 DAP

LED-ill. push button SL 17,  
17mm diameter,  
faston terminals 2,8x0,8mm, red LED,  
red colored flat lens, 24 VDC,  
colorless anodized aluminum housing,  
plastic nut M14x1, O-ring NBR 70



### Upon request

- other voltages
- common anode
- other connectors
- flashing LED
- other housing colors
- lettering on illuminated surface

## Manufacturer

W. Schmid AG  
Dorfstrasse 23  
5442 Fislisbach  
Switzerland

Tel: +41 56 470 00 77 Fax: +41 56 470 00 74

E-mail: [sales@led-lamps.ch](mailto:sales@led-lamps.ch) URL: <http://www.led-lamps.ch>